

TYPE	YEAR	PROJECT NO.	SHEET NO.
R.O.W.	2014	NH-I-640-7(161)	21-G
CONST.	2016	NH-I-640-7(161)	21-G

KNOX CO. I-640
47008-3150-44 (CONST.)

REV. 01-15-16; REVISED PHASING
NOTES

Phase 2 Construction

Ramp 2
Shift S.R. 33 North to I-640 WB Traffic onto newly constructed Ramp 2.

Ramp 1
Shift Ramp 1 traffic to newly constructed ramp. Construct BRamp1 from bridge over Tazewell Pike to Sta. 66+09± (left shoulder) and Sta. 66+31± (lanes and right shoulder tie to Ramp 1). Construct Retaining Wall 5. Begin construction of left side of ramp from Sta. 9+53± to I-640 bridge over Old Broadway. Begin construction of Retaining Wall 10.

I-640
Begin construction of Wall 4 and complete widening from Sta. 134+93± to bridge over SR33 (Broadway).

S.R. 33 (Broadway)
Maintain two lanes of traffic in each direction at all times. Complete construction of Wall 6 and widening from Sta. 20+20± to end. Complete construction of Bridge 4 (over SR331, Tazewell Pike). Complete median construction from Sta. 13+65± to Sta. 15+80±.

Greenway Drive
Mill and overlay existing pavement and complete final striping.

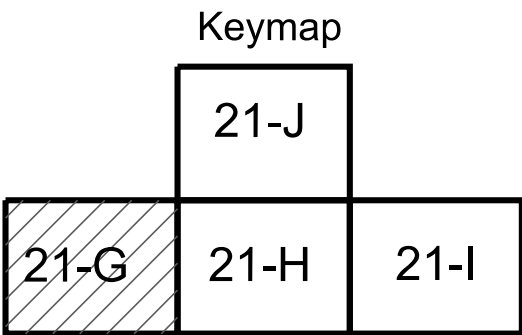
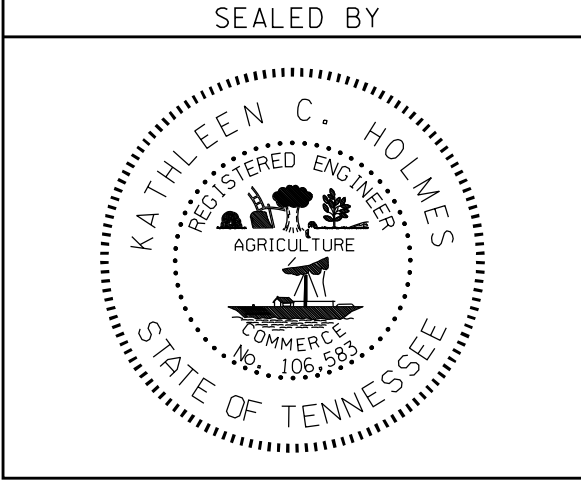
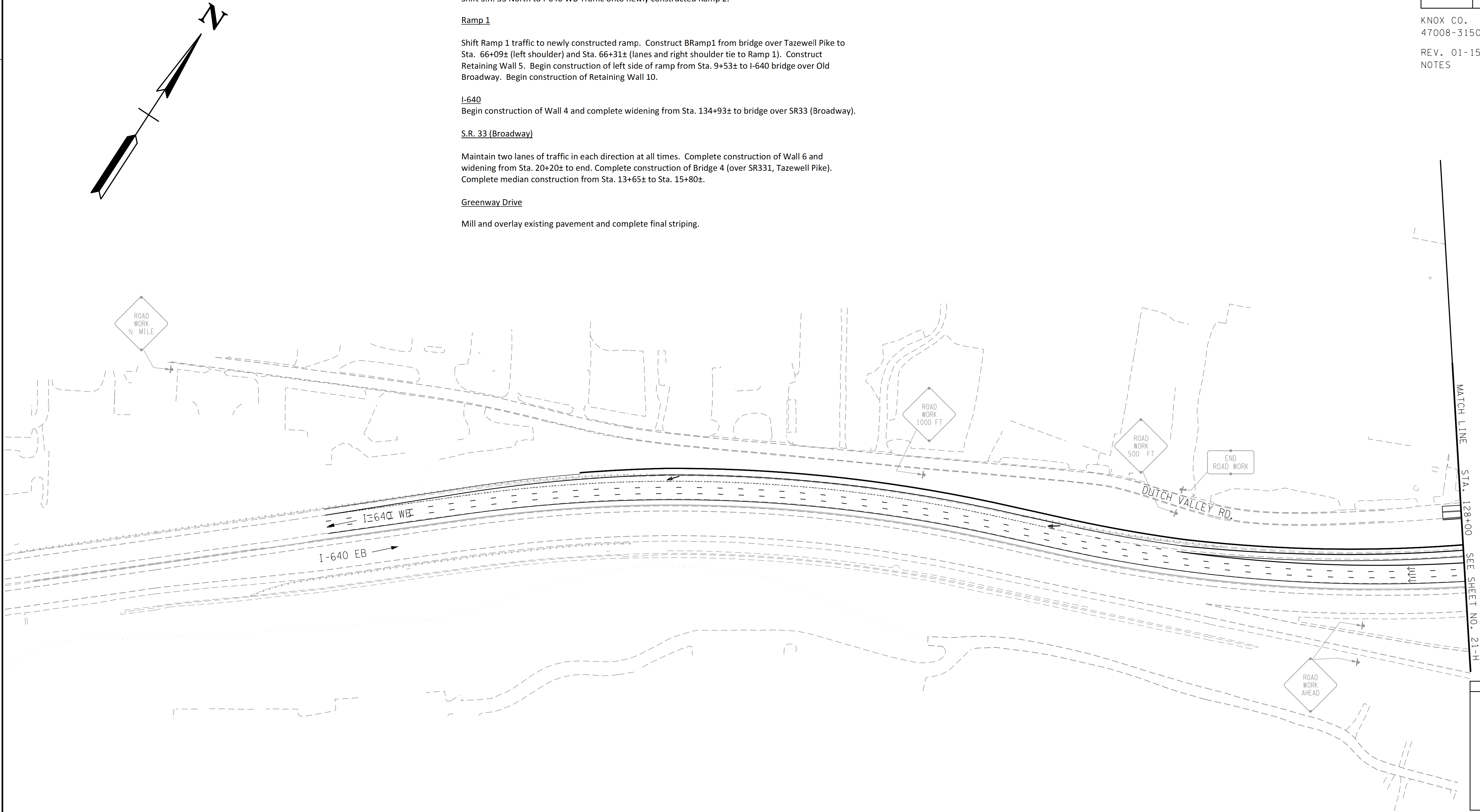

STATE OF TENNESSEE
DEPARTMENT OF TRANSPORTATION

MAINTENANCE
OF TRAFFIC
PHASE 2

SCALE: 1"= 100'